

Entertainment and Hospitality Project Information



Product: SQUARELINE® Metal Ceiling Tiles
Application: Concourse of Reliant Stadium
Architect: Lockwood, Andrews and Newman, Inc.



Product: CONTOUR® Ceiling Tiles
Application: Learning resource center



Product: SONEX® Panels in charcoal colortec®
Application: Restaurant



Product: CONTOUR Ceiling Tiles
Application: Ballroom in historic manor

To learn more about these and other applications, visit our website at www.pinta-acoustic.com/ent.

Entertainment and Hospitality Project Information



Product: SQUARELINE® Metal Ceiling Tiles
Application: Theater performing arts
Architect: Beyer Blinder Belle Architects and Planners, LLP



Product: CONTOUR® Ceiling Tiles
Application: Cafeteria
Architect: Turok Architecture, Inc.

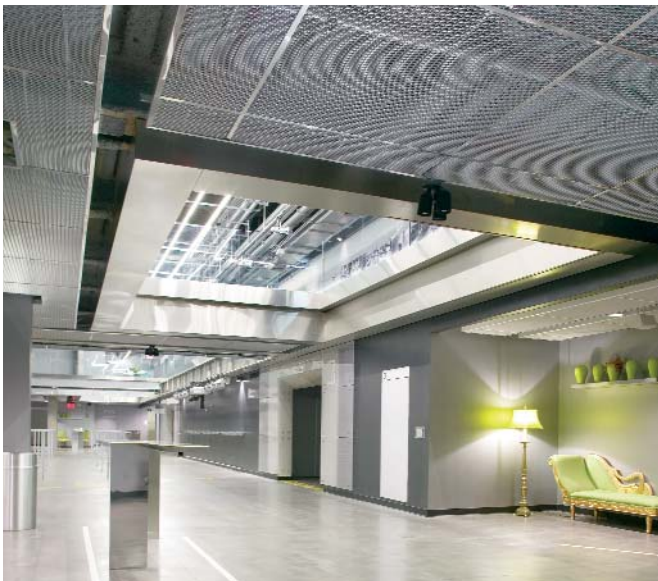

Product: SQUARELINE Metal Ceiling Tiles
Application: Theater performing arts
Architect: Beyer Blinder Belle Architects and Planners, LLP



Product: CONTOUR Ceiling Tiles
Application: Dining room

To learn more about these and other applications, visit our website at www.pinta-acoustic.com/ent.